



Licensed Volvo XC90

Kids Ride on Car

Installation and Operation Instructions



Please read this instruction manual carefully. It is important to read and follow all of the steps during assembly to ensure proper operation and safety of the child. Please keep this manual for future reference.



**Scan this QR Code
to view the
Assembly Video**

SPECIFICATIONS:

Battery Type:	12V10AH	Avg. Speed:	2 – 5 MPH
Age Range:	2 – 6 Years	Charging time:	8-12 hrs – Minimum 1 Charge per month
Max. Weight:	75 lbs	Avg. Use Time:	48-90 Minutes (depending on use)
Product Size:	51”L x 26”W x 25”H	Remote Battery:	2 - AAA (not included)

IMPORTANT!

<ul style="list-style-type: none"> Assembly of car and charging of battery is only to be done by an adult.  	<ul style="list-style-type: none"> WARNING!! NOT TO BE USED ON STREETS or IN TRAFFIC.
<ul style="list-style-type: none"> Never modify the electric circuit system or tamper with electric system. Can cause permanent damage. 	<ul style="list-style-type: none"> Please check the product regularly for any loose parts or wires to ensure proper operation.
<ul style="list-style-type: none"> Adult supervision is recommended during operation by child to avoid injury. Safety equipment is recommended. 	<ul style="list-style-type: none"> Please make sure that the child uses caution to avoid falls and collisions causing injury to the child or third party.
<ul style="list-style-type: none"> Do not pick up vehicle by steering wheel. 	<ul style="list-style-type: none"> Do not pick up battery by wires or charger.
<ul style="list-style-type: none"> Keep all plastic bags out of the reach of young children. 	<ul style="list-style-type: none"> Not recommended for children under the age of 2 yrs. due to small parts that could cause a choking hazard.
<ul style="list-style-type: none"> Battery must be charged for a minimum of 8-12 hours prior to first use of the car to avoid damage to the battery. Power switch must be in off position when charging. 	<ul style="list-style-type: none"> Battery charger should be examined for damage prior to each use. It is important to inspect the cord and both ends for damage. If damage is found, DO NOT USE THE CHARGER! Contact us for replacement charger.
<ul style="list-style-type: none"> Please retain instruction manual for future reference. 	<ul style="list-style-type: none"> Please retain packaging in the event it is necessary to return.

If the charger is plugged into the charging port, the car will not power up regardless if the charger is plugged into the wall outlet or not.

1:All spare parts when opens the carton

Car Body 1 PC	Steering wheel 1 PC	Seat 1 PC	Front Wheels 2 PCS
Back Wheels 2 PCS	Rear View Mirrors 1 Pair	Charger 1 PC	Remote Control 1 PC
Screw package 1PCS			



[All assembly videos can be found on YouTube under SPORTrax](#)

2: Installation of Headrest onto Seat: Locate the Headrests and Seat from the parts. Snap the corresponding headrest (R) in the right side of the top of the seat. Snap the corresponding headrest (L) in the left side of the top of the seat.



3: Installation of Rear View Mirror: Locate rear view mirrors from parts. Insert each mirror into the correct position on each door.
NOTE: One mirror will install properly on the left door and one will install properly on the right door.



4: Installation of the Seat: Place the seat assembly into the correct location of the car (directly over the location of the battery) use screws provided to secure seat to body of car.

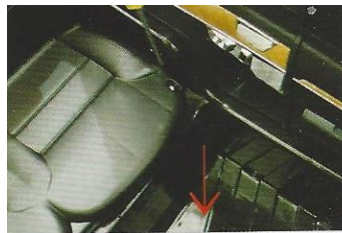
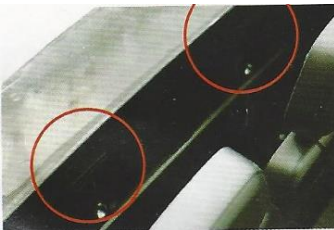

5: Installation of front wheels and wheel covers:

Locate the 2 wheels that do not have the hub attached to them. (Wheels will be flat on both sides) Insert the small black plastic bushings into the center hole on the back side of the wheel. Install a flat washer onto each of the front axles. Slide one wheel onto the front axle on each side of the car. While sliding the wheel onto the axle, press the center button of the wheel and slide wheel on completely and let go of center button. Pull gently on the wheel to make sure that wheel is locked into place.

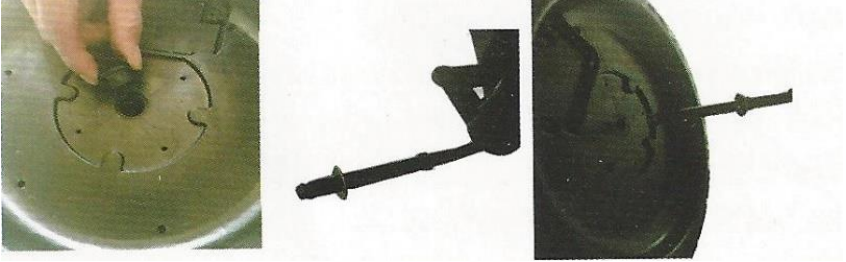

6: Installation of the rear wheels and wheel covers:

The remaining 2 wheels will have a hub on the back side of the wheel. Insert small black plastic bushings into the center hole on the back side of the wheel. Slide one wheel onto the rear axle on each side of the car. You will need to line up the hub with the motor on the axle. While sliding the wheel onto the axle, press the center button of the wheel and slide wheel on completely and let go of center button. Pull gently on the wheel to make sure that wheel is locked into place.



7: Installation of the steering wheel:

Remove nut and bolt from the steering wheel assembly. Connect the wire connector from the steering wheel to the corresponding connector at the steering column. Slide the steering wheel onto the steering shaft while feeding the wire connector into the steering column. Line up the hole in the steering column to the hole through the steering wheel assembly and slide bolt through. Secure with the nut.

NOTE: Due to possible movement in the steering shaft through the column, the hole in the steering shaft may not line up with the hole through the steering wheel assy. If this happens, use one hand under the car and push the steering shaft upward while attempting to line up the holes for the bolt to secure the steering wheel. Please see photo.

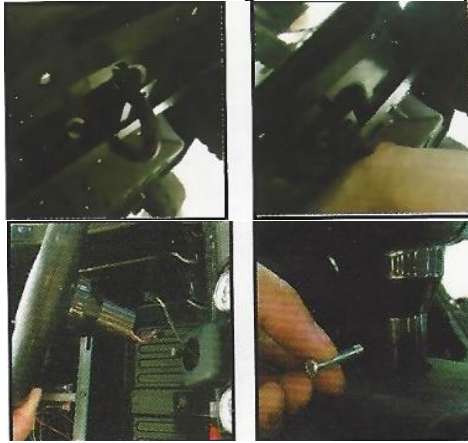

Main Functions

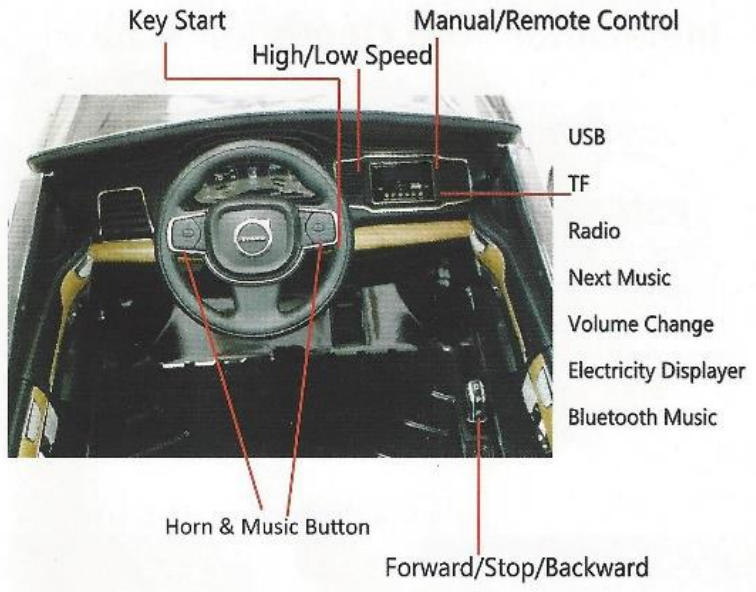

Remote Control Function



Operating the remote control

1. Install batteries.
2. Remote lights will flash briefly and then go out.
2. With the lights on the remote off and the car "OFF" press and hold the car select button. (The lights on the remote will come on.) While holding the "car select" button, turn on the car. Continue holding the "car select" button throughout the synching process. When the "car select" light goes out, the remote is synching to the car. STOP Button=Parking brake

Music Player Function



1. Press once to change to the story time feature. Press for about 3 seconds to lower the volume.
2. Press to change to the music feature. Press for about 3 seconds to raise the volume.
3. Press once to change to the next song. Long press for about 3 seconds to pause.
4. Press to change the education feature.

BATTERY REPLACEMENT AND DISPOSAL:

The battery will eventually lose the ability to hold a charge. Depending on the amount of use, and varying conditions, the battery should operate for one to three years. Follow these steps to replace and/or dispose of the battery:

- Remove the cars seats
- Disconnect the battery connectors
- Remove the metal battery bracket
- Carefully lift the battery - you may want to wear protective gloves before removal - **Do Not** lift the battery by its connectors or cables
- Place the dead battery in a plastic bag
- Replace the battery and reconnect the connectors
- Replace the metal battery bracket
- Replace the seat

WARNING:

- Use only the rechargeable battery and charger supplied with your vehicle. **NEVER** substitute the battery or charger with another brand. Using another battery or charger may cause damage.
- **NEVER** modify the electric circuit system. Tampering with the electric system may cause permanent damage to the system.
- **Do not** allow direct contact between battery terminals.
- **Do not** allow any type of liquid on the battery or its components.
- Charge the battery in a well-ventilated area **ONLY**. Do not charge near or around flammable materials.
- **NEVER** pick up the battery by the wires or charger. Damage can occur to the battery and may cause a fire. Pick up the battery by the case **ONLY**.
- Charge the battery in a dry area **ONLY**.

Wash hands after handling.

- **Do not** open the battery. Battery contains lead acid and other materials that are toxic and corrosive.
- **Do not** open the charger. Exposed wiring and circuitry inside case could cause electric shock. **NEVER** allow a child to handle or charge the battery. Battery is heavy and contains lead acid (electrolyte).
- **Do not** drop the battery. Permanent damage to the battery could occur or cause serious injury.
- Before charging the battery, check for wear or damage to the battery, charger, its supply cord and the connectors. **DO NOT** charge the battery if any damage to parts has occurred.
- **Do not** allow the battery to drain completely. Recharge the battery after each use or once per month if not used regularly.
- **Do not** charge the battery upside down.
- **Always** secure the battery with the bracket. Battery can fall out and injure a child if vehicle tips over.
- The **Power Switch** must be turned in the **OFF** position when charging.
- When the car begins to run slowly, recharge the battery.

GENERAL MAINTENANCE:

It is the parent's responsibility to check main parts of the toy before using. Regularly examine the car for potential hazard, such as damage to the battery, charger, cable or cord, and plug. Also, check that all screws are tightened throughout the car. In the event of such damage, the toy must not be used until that damage is repaired or replaced.

- Make sure the plastic parts of the vehicle are not cracked or broken.
- Occasionally use a lightweight oil to lubricate moving parts such as wheels.
- Park the vehicle indoors or cover it with a tarp to protect it from wet weather.
- Keep the vehicle away from sources of heat, such as stoves and heaters. Plastic parts may melt.
- Recharge the battery after each use. Only an adult should handle the battery. Recharge the battery at least once a month when not being used.
- Do not wash the vehicle with a hose. Do not wash the vehicle with soap and water. Do not drive the vehicle in rainy or snowy weather as water will damage the motor, electric system and battery.
- Clean the vehicle with a soft, dry cloth. To restore shine to plastic parts, use a non-wax furniture polish. Do not use car wax. Do not use abrasive cleaners.
- Do not drive the vehicle in loose dirt, sand or fine gravel which could damage moving parts, motors or the electric system.
- For extended times when the car will not be used, the power switch needs to be in the off position and the electrical connections should be disconnected from the battery.

TROUBLE SHOOTING GUIDE:

Problem	Possible Cause	Possible Solutions
Car will not move	<ol style="list-style-type: none"> 1. Battery voltage is low. 2. Battery connector or wires are loose. 3. Battery is damaged or dead. 4. Electrical box or motor is damaged 	Charge the battery Re-connect the battery connector to the car Replace battery Replace motor
The battery will not charge.	<ol style="list-style-type: none"> 1. Battery connector may have come apart or have a bad connection. 2. Battery charger plugged into a bad wall outlet. 3. Battery charger is damaged. 	Re-connect the battery connector to the car electrical connector Try another wall outlet Replace battery charger
Shortened battery life	Battery was not charged fully Battery is old	Charge battery fully Change battery
Some Noise and heat when charging battery	Chemical reaction	Normal
Low Speed	Battery is old Battery is low on charge Weight limit exceeded Uneven or uphill path Vehicle is being used in harsh conditions	Change the battery Charge the battery Do not exceed max weight limit Use on flat surfaces Avoid using car in harsh conditions
Noise coming from motor/gearbox	Gear in motor/gearbox broken	Call for replacement motor
The car shakes when moving	Bad Connection of the motor wires Possible motor failure	Reconnect wires Call for replacement motor
Car needs a push to go forward	Poor contact of wires and/or connectors "Dead Spot" on motor	Check that the battery connectors are firmly plugged into each other. If wires are loose around the motor, contact the distributor's service department A dead spot means the electric power is not being delivered to the terminal connection. Call our service department

Self-Resetting Breaker – The vehicle is equipped with a self-resetting breaker. In the event the power is tripped the breaker will reset itself in approximately one minute.

If you are unable to solve a problem, please feel free to contact us.

Phone: 402-477-0541 or Email: customerservice@rollinghillstrading.com