



Rolls Royce Style Kids Ride on Car Installation and Operation Instructions



Please read this instruction manual carefully. It is important to read and follow all of the steps during assembly to ensure proper operation and safety of the child. Please keep this manual for future reference.



**Scan this QR Code to view the
Rolls Royce Assembly Video**

SPECIFICATIONS:

Car Type:	Rolls Royce Style
Battery Type:	6V7AH
Electric Motor:	12V30W(Drive) 12V8W(Steering)
Age Range:	2 – 5 Years
Max. Weight:	65 lbs
Product Size:	50"L x 34"W x 25"H
Avg. Speed:	2 – 3 MPH
Charging time:	8-12 hrs
Avg. Use Time:	1-2 Hrs (depending on use)
Remote Battery:	2 - AA (not included)

IMPORTANT!

- Assembly is required by an adult
- Keep small parts out of reach of young children. (To avoid choking potential)
- Adult supervision is recommended during operation by child to avoid injury.
- Charger connection should be performed by an adult.
- Battery must be charged for a minimum of 12 hours prior to first use of the car to avoid damage to the battery.
- Keep all plastic bags out of the reach of young children.
- Please check the product regularly for any loose parts or wires to ensure proper operation.
- Please retain instruction manual for future reference.
- Please make sure that the child uses caution to avoid falls and collisions causing injury to the child or third party.
- Not recommended for children under the age of 2 yrs. Due to small parts that could cause a choking hazard.
- Battery charger should be examined for damage prior to each use. It is important to inspect the cord and both ends for damage. In the event there is damage found, DO NOT USE THE CHARGER! Contact us for replacement charger.
- Please retain packaging in the event it is necessary to return for repair.
- WARNING!! NOT TO BE USED ON STREETS or IN TRAFFIC.

PARTS LIST:

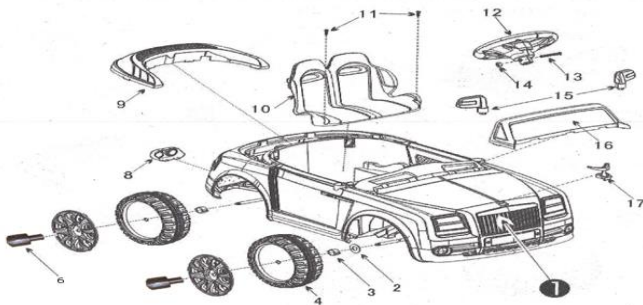

1	Car Body	8	Tail Pipe	14	Steering Bolt
2	Washer	9	Rear Spoiler	15	Rearview Mirrors
3	Bushing	10	Seat	16	Front Windshield
4	Wheel	11	Seat Screw	17	Hood Ornament
5	Seat	12	Steering Wheel		
6	Tire Quick Connect	13	Steering Screw		

ASSEMBLY INSTRUCTIONS:

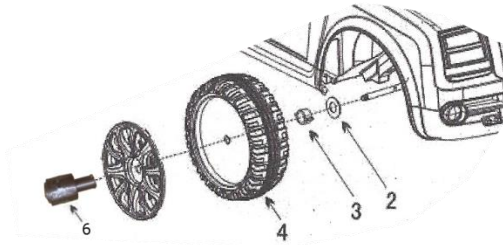

1. **Installing the Front Wheels:** Prior to installing the front wheels, locate the brown wheel cap found on both ends of the front axle, press down on the button located within the center of the wheel cap and hold to remove the wheel cap from axle. Once wheel cap is removed, install washer (found in parts package) followed by installing the bushing (found in parts package) into the center of the wheel. Then, install the front wheel onto the front axle, followed by the wheel cap by inserting the wheel cap into the center of the wheel until you hear a click.

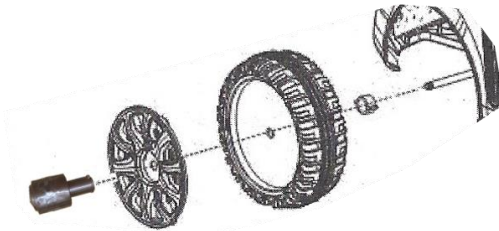

2. **Installing the Rear Wheels:** Prior to installing the rear wheels, locate the brown wheel cap found on both ends of the rear axle, press down on the button located within the center of the wheel cap and hold button to remove the wheel cap from the axle. Once wheel cap is removed, install the bushing (found in parts package) into the center of the wheel. Then, install the rear wheel onto the rear axle, followed by the wheel cap by inserting the wheel cap into the center of the wheel until you hear a click.

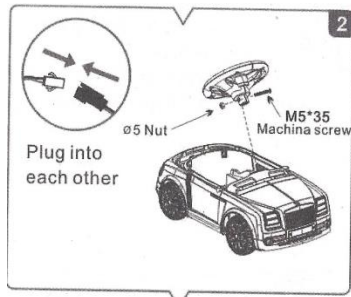

3. **Installing Steering Wheel:** Locate the music/horn wire at the end of the steering wheel, and connect it to the power wire located on the steering rod. Once wires are connected, remove screw and nut located on the steering wheel column. Once screw and nut are removed, align hole on steering column with the hole located on the steering rod. Insert screw through the hole, followed by tightening the screw to the nut until tight.

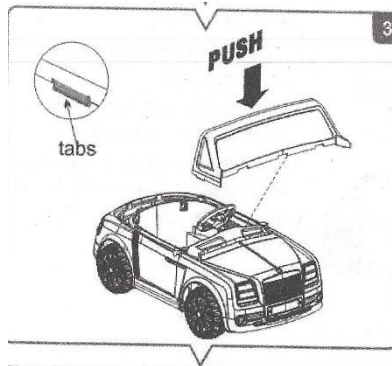

4. **Windshield Installation:** To install the windshield into the body of the car, align the tabs located at the bottom of the windshield with the holes located above the dash board at the front of the car. Insert tabs into the holes, and push down until you hear a click.

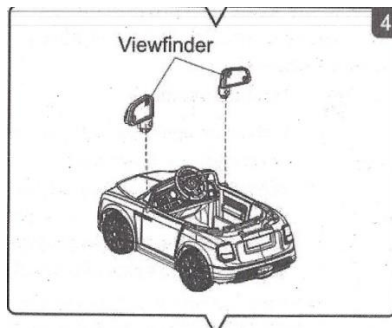

5. **Installing Rearview Mirrors:** Fit the tabs on the bottom of the Rearview Mirrors into the slots on the side of the vehicle body towards the front of the door. Push down until you hear a click.

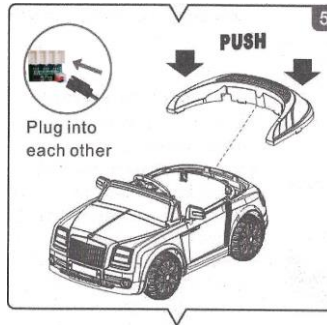

6. **Installing the Rear Spoiler:** Locate the wire at the bottom of the rear spoiler. Feed the wire through the open slot at the top of the rear of the car and connect the wire to any of the 4 white slots located on the white power board. Once connected place spoiler tabs into the open slots at the rear of the car and push until you hear a click.

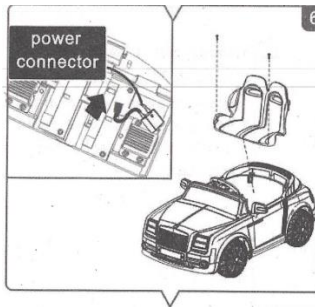

7. **Installing Seat:** Insert the seat into the 2 open holes located at the rear of the car's interior. To make sure seat is secure, screw 2 bolts into holes located at the front of the seat on the left and right hand side.

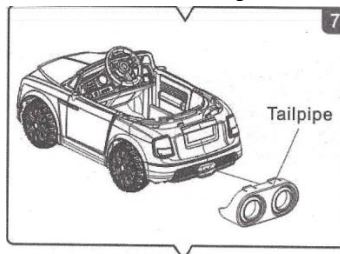

8. **Installing the Tailpipe:** Fit the tailpipe into the slots located at the bottom rear of the vehicle body. Push the tailpipe into the slot until you hear a click.

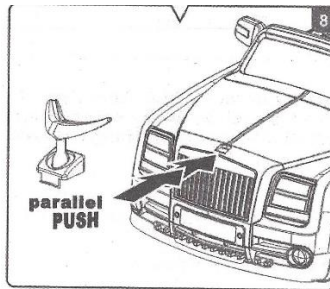

9. **Hood Ornament:** Insert the tabs located at the bottom of the hood ornament into the slots located at the front of the vehicle hood.

Charging the battery: The charging port is located on the dash to the right of the steering wheel. Plug the charger into the charging port first, then plug the charger into wall outlet. **BATTERY MUST BE CHARGED FOR A MINIMUM OF 12 HOURS BEFORE INITIAL USE TO AVOID DAMAGE TO THE BATTERY.**

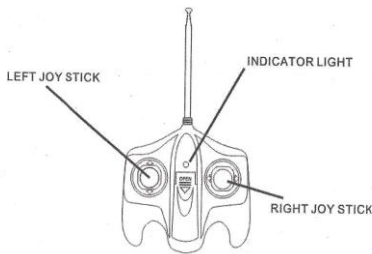

REMOTE CONTROL BATTERY INSTALLATION: Open battery cover on the back of the remote control. Install 2 AA Batteries as indicated inside the cover. Replace battery cover and secure with screw.

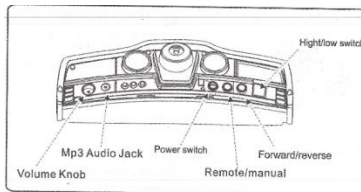
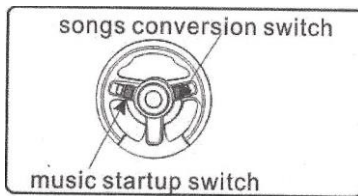

Once battery is fully charged, disconnect from charger. Depress power button to turn on the car. Once power is on, all lights light up, accompanied by the sound of the engine. (If

no sound is heard, turn up the volume) To allow child to operate the car, remote control/manual switch has to be set to the manual position. To move the car forward, forward/reverse switch has to be set to the forward position and to move the car backward, the switch will need to be set to the reverse position. To operate the car using the remote control, remote control/manual switch has to be set to the remote control position.

The buttons found on the handlebars are for the horn and the on board music. There is a MP3 interface located on the dash area with a volume knob to control the level of sound.

TROUBLE SHOOTING GUIDE:

Problem	Possible Cause	Possible Solutions
Car will not move	<ol style="list-style-type: none"> 1. Battery voltage is low. 2. Screw on the wheels may have come loose. 3. Battery connector may have come apart or have a bad connection. 4. Battery is damaged 5. Electrical box is damaged 6. Motor is damaged 	Charge the battery Re-tighten screws on wheels. Re-connect the battery connector to the car electrical connector Replace battery Replace motor
The battery will not charge.	<ol style="list-style-type: none"> 1. Battery connector may have come apart or have a bad connection. 2. Battery charger plugged into a bad wall outlet. 3. Battery charger is damaged. 	Re-connect the battery connector to the car electrical connector Try another wall outlet Replace battery charger
Shortened battery life	Battery was not charged fully Battery is old	Charge battery fully Change battery
Some Noise and heat when charging battery	Chemical reaction	Normal
Low Speed	Battery is old Battery is low on charge Weight limit exceeded Uneven or uphill path	Change the battery Charge the battery Do not exceed max weight limit
Noise coming from motor/gearbox	Gear in motor/gearbox broken	Call for replacement motor
The car shakes when moving	Bad Connection of the motor wires Possible motor failure	Reconnect wires Call for replacement motor

If you are unable to solve a problem, please feel free to contact us.

IMPORTANT REMINDERS:

- Prior to first use of this electrical vehicle, please charge the battery for a minimum of 12 hours. Failure to complete this step will cause permanent damage to the battery.
- Do not operate on streets, roads, steep slopes, through ditches or in any dangerous areas.
- Do not operate on slick surfaces, such as; marble, floor tile, ice.
- This product is limited to one rider. **DO NOT OVERLOAD.** Max weight 65 pounds!
- Do not switch forward to reverse while vehicle is in motion.
- Keep car, remote control, and charger away from water and/or rain to avoid circuit damage
- Do not continue operation when car is stopped by an obstacle. Move car away from obstacle prior to resuming operation.
- Do not use in or near water.
- Any liquid in the car may cause damage.
- Not for indoor use, may cause damage to furniture, walls, and other third party.
- When remote control batteries are discharged, the car will become sluggish and jitter, replace batteries.
- When not in use, please turn off power switch. If not using for an extended period of time, please disconnect the battery.

CHARGING and BATTERY MAINTENANCE:

- **IMPORTANT!** Battery must be charged for a minimum of 12 hours prior to first use of the car to avoid damage to the battery.
- When connecting the charger, please install the plug into the car prior to plugging charger into the wall socket.
- Charging time for battery is 8-12 hours
- **DO NOT EXCEED 20** hours when charging.
- Only use the battery supplied with this car to avoid damage to the car.
- Adult supervision is advised for connecting charger.
- Never reverse polarity of the battery + to red and – to black.
- Never short circuit battery! Do not touch red wires to black wires.
- For remote control: it is not recommended to use rechargeable batteries.

WARNING:

Please keep small parts away from children to avoid choking.

GENERAL MAINTENANCE:

1. It is important to recheck all parts and components that were installed periodically to ensure proper operation.
2. For cleaning, simply wipe off with damp cloth.

3. Visual inspection and appropriate maintenance is necessary to maintain the safety of your child.
4. Maintain the safety of your child.