



Can Am Style Kids Ride on Car Installation and Operation Instructions



Please read this instruction manual carefully. It is important to read and follow all of the steps during assembly to ensure proper operation and safety of the child. Please keep this manual for future reference.

SPECIFICATIONS:

Car Type:	Can Am Style
Battery Type:	12V7AH
Electric Motor:	12V30W(Drive) 12V8W(Steering)
Age Range:	2 – 5 Years
Max. Weight:	65 lbs
Product Size:	42”L x 26”W x 24”H
Avg. Speed:	2 – 3 MPH
Charging time:	8-12 hrs
Avg. Use Time:	1-2 Hrs (depending on use)
Remote Battery:	2 - AAA (not included)

IMPORTANT!

- Assembly is required by an adult
- Keep small parts out of reach of young children. (To avoid choking potential)
- Adult supervision is recommended during operation by child to avoid injury.
- Charger connection should be performed by an adult.
- Battery must be charged for a minimum of 12 hours prior to first use of the car to avoid damage to the battery.
- Keep all plastic bags out of the reach of young children.
- Please check the product regularly for any loose parts or wires to ensure proper operation.
- Please retain instruction manual for future reference.
- Please make sure that the child uses caution to avoid falls and collisions causing injury to the child or third party.
- Not recommended for children under the age of 2 yrs. Due to small parts that could cause a choking hazard.
- Battery charger should be examined for damage prior to each use. It is important to inspect the cord and both ends for damage. In the event there is damage found, DO NOT USE THE CHARGER! Contact us for replacement charger.
- Please retain packaging in the event it is necessary to return for repair.
- **WARNING!! NOT TO BE USED ON STREETS or IN TRAFFIC.**

PARTS LIST:

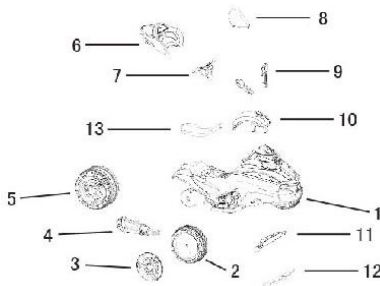

1	Car Body	6	Toolbox	11	Lower Bracket
2	Front Wheels	7	Handlebars	12	Steering Rod
3	Wheel Covers	8	Windshield	13	Seat
4	Exhaust Pipe	9	Rearview Mirror		
5	Rear Wheel	10	Front Fairing		

ASSEMBLY INSTRUCTIONS:

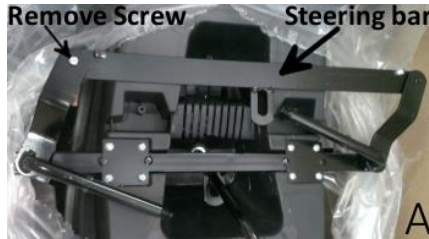

1. Car is shipped with the front axles pointed to the center of the vehicle. Unscrew nut that connects the steering bar to the front axle and remove the bolt. Make sure that you keep this bolt and nut for future step. (see Image A)

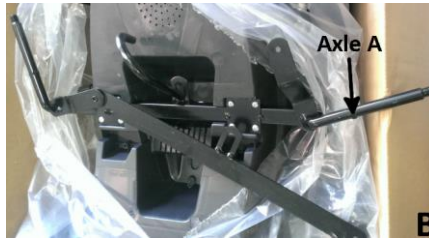

2. Rotate axle A, closest to the screw removed, so that it is pointing to the outside of the vehicle. (See Image B)

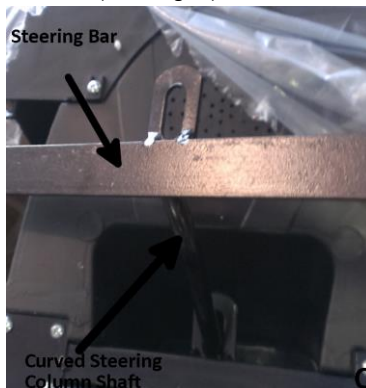

3. Rotate the axle that is still connected to steering bar, toward the front of the car. You will need to slightly bend steering bar over the curved steering column shaft to get completely rotated. (See Image C)

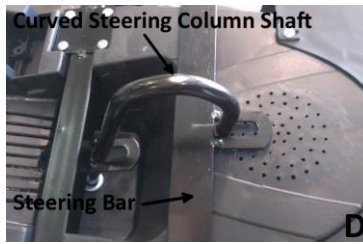

4. Slide steering bar under curved steering column shaft so that the end of the steering column shaft fits into the slot in the steering bar.
(See Image D)

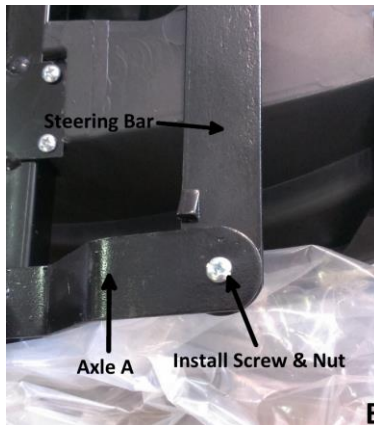

5. Re-Install screw, previously removed in step 1, to attach the steering bar to axle A. Tighten so nut is snug. (See Image E)

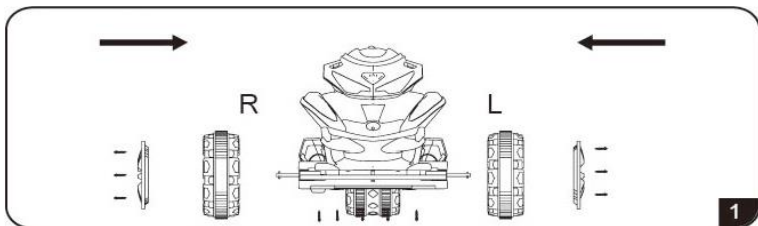

6. Install the front wheels. Place a flat washer on each front axle shaft. Install one tire/wheel on each axle shaft. Place a flat washer on each axle and secure with lock nut. Use tool supplied to tighten lock nut until snug.
7. Install wheel covers: Set wheel covers into place on the outside of the wheel. Using the small screws supplied, secure the wheel covers to the wheels through the three drilled holes in the wheel covers. Do not over tighten to avoid damage to the wheel covers. (See Image 1)

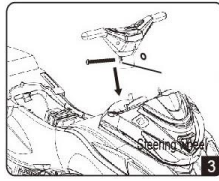

8. Install the handlebars:

Connect electrical connection from the handlebars to the corresponding connector on the car. Remove the nut and bolt from the steering shaft. Place the handlebar over the shaft and line up the hole in the handlebar to the hole in the steering shaft and install the bolt through the hole and tighten the nut onto the bolt to secure.

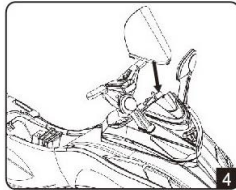

9. Install Windshield:

Place the windshield in the direction of the arrow in to the corresponding slots and press into place.

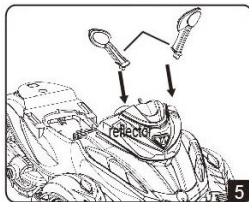

10. Install rearview mirrors:

Place mirrors in the direction of the arrows into the corresponding holes and press into place.

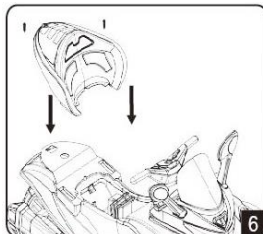

11. Install the trunk:

Remove the screw that is located at the rear of the seat. Place trunk onto the area behind the seat and secure with small screws. (Included)

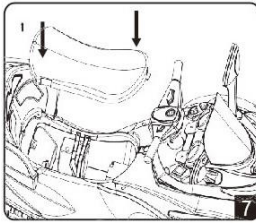

12. Install Seat:

Before placing the seat, connect the electrical plug from the battery to the corresponding plug from the wiring to the car. Once connection is made, place the seat over the battery area front first and re-apply screw to secure.

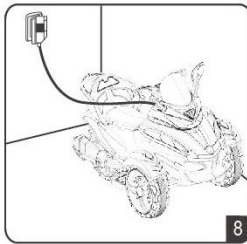

13. Charging Port:

The charging port is located just below the handlebars. Lift charging port cover and plug in charger. Once charger is connected to the car, plug into wall outlet.

BATTERY MUST BE CHARGED FOR A MINIMUM OF 12 HOURS BEFORE INITIAL USE TO AVOID DAMAGE TO THE BATTERY.

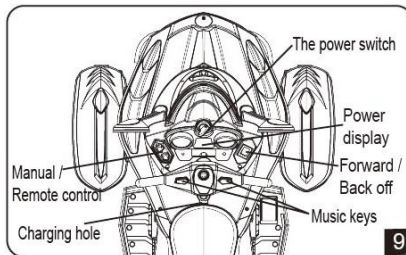

14. Once battery is fully charged, disconnect from charger. Depress power button to turn on the car. Once power is on, all lights light up, accompanied by the sound of the engine. To allow child to operate the car, remote control/manual switch has to be set to the manual position. To move the car forward, forward/reverse switch has to be set to the forward position and to move the car backward, the switch will need to be set to the reverse position. To operate the car using the remote control, remote control/manual switch has to be set to the remote control position.

The buttons found on the handlebars are for the horn and the on board music. There is a MP3 interface located on the dash area with a volume knob to control the level of sound.

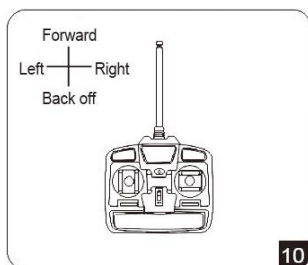

The function of the remote control: with the remote control/manual switch in the remote control position, to make car move forward, push the forward/reverse button up. To move the car backward, push the forward/reverse button down. Push the left/right button left to make the car go left. Likewise, to make the car go right push the left/right button to the right.

TROUBLE SHOOTING GUIDE:

Problem	Possible Cause	Possible Solutions
Car will not move	<ol style="list-style-type: none"> 1. Battery voltage is low. 2. Screw on the wheels may have come loose. 3. Battery connector may have come apart or have a bad connection. 4. Battery is damaged 5. Electrical box is damaged 6. Motor is damaged 	Charge the battery Re-tighten screws on wheels. Re-connect the battery connector to the car electrical connector Replace battery Replace motor
The battery will not charge.	<ol style="list-style-type: none"> 1. Battery connector may have come apart or have a bad connection. 2. Battery charger plugged into a bad wall outlet. 3. Battery charger is damaged. 	Re-connect the battery connector to the car electrical connector Try another wall outlet Replace battery charger
Shortened battery life	Battery was not charged fully Battery is old	Charge battery fully Change battery
Some Noise and heat when charging battery	Chemical reaction	Normal
Low Speed	Battery is old Battery is low on charge Weight limit exceeded Uneven or uphill path	Change the battery Charge the battery Do not exceed max weight limit
Noise coming from motor/gearbox	Gear in motor/gearbox broken	Call for replacement motor
The car shakes when moving	Bad Connection of the motor wires Possible motor failure	Reconnect wires Call for replacement motor

If you are unable to solve a problem, please feel free to contact us.

IMPORTANT REMINDERS:

- Prior to first use of this electrical vehicle, please charge the battery for a minimum of 12 hours. Failure to complete this step will cause permanent damage to the battery.
- Do not operate on streets, roads, steep slopes, through ditches or in any dangerous areas.
- Do not operate on slick surfaces, such as; marble, floor tile, ice.
- This product is limited to one rider. **DO NOT OVERLOAD.** Max weight 65 pounds!
- Do not switch forward to reverse while vehicle is in motion.
- Keep car, remote control, and charger away from water and/or rain to avoid circuit damage
- Do not continue operation when car is stopped by an obstacle. Move car away from obstacle prior to resuming operation.
- Do not use in or near water.
- Any liquid in the car may cause damage.
- Not for indoor use, may cause damage to furniture, walls, and other third party.
- When remote control batteries are discharged, the car will become sluggish and jitter, replace batteries.
- When not in use, please turn off power switch. If not using for an extended period of time, please disconnect the battery.

CHARGING and BATTERY MAINTENANCE:

- **IMPORTANT!** Battery must be charged for a minimum of 12 hours prior to first use of the car to avoid damage to the battery.
- When connecting the charger, please install the plug into the car prior to plugging charger into the wall socket.
- Charging time for battery is 8-12 hours
- **DO NOT EXCEED 20** hours when charging.
- Only use the battery supplied with this car to avoid damage to the car.
- Adult supervision is advised for connecting charger.
- Never reverse polarity of the battery + to red and – to black.
- Never short circuit battery! Do not touch red wires to black wires.
- For remote control: it is not recommended to use rechargeable batteries.

WARNING:

Please keep small parts away from children to avoid choking.

GENERAL MAINTENANCE:

1. It is important to recheck all parts and components that were installed periodically to ensure proper operation.
2. For cleaning, simply wipe off with damp cloth.
3. Visual inspection and appropriate maintenance is necessary to maintain the safety of your child.
4. Maintain the safety of your child.