



Adventurer  
Emergency Response  
Kids Ride on Car  
Installation and Operation Instructions



Please read this instruction manual carefully. It is important to read and follow all of the steps during assembly to ensure proper operation and safety of the child. Please keep this manual for future reference.



**Scan this QR Code  
to view the  
Assembly Video**

**SPECIFICATIONS:**

Battery Type:	12V10AH	Avg. Speed:	2 – 3 MPH
Age Range:	2 – 6 Years	Charging time:	8-12 hrs – Minimum 1 Charge per month
Max. Weight:	80 lbs	Avg. Use Time:	48 - 90 Minutes (depending on use)
Product Size:	47.25”L x 30”W x 21.73”H	Remote Battery:	2 - AAA (not included)

### IMPORTANT!

<ul style="list-style-type: none"> <li>Assembly of car and charging of battery is only to be done by an adult. </li> </ul>	<ul style="list-style-type: none"> <li><b>WARNING!! NOT TO BE USED ON STREETS or IN TRAFFIC.</b></li> </ul>
<ul style="list-style-type: none"> <li>Never modify the electric circuit system or tamper with electric system. This can cause permanent damage.</li> </ul>	<ul style="list-style-type: none"> <li>Please check the product regularly for any loose parts or wires to ensure proper operation.</li> </ul>
<ul style="list-style-type: none"> <li>Adult supervision is recommended during operation by child to avoid injury. Safety equipment is recommended.</li> </ul>	<ul style="list-style-type: none"> <li>Please make sure that the child uses caution to avoid falls and collisions, which could cause injury to the child or third party.</li> </ul>
<ul style="list-style-type: none"> <li><b>Do not</b> pick up vehicle by steering wheel.</li> </ul>	<ul style="list-style-type: none"> <li><b>Do not</b> pick up battery by wires or charger.</li> </ul>
<ul style="list-style-type: none"> <li>Keep all plastic bags out of the reach of young children.</li> </ul>	<ul style="list-style-type: none"> <li>Not recommended for children under the age of 2 yrs. due to small parts that could cause a choking hazard.</li> </ul>
<ul style="list-style-type: none"> <li>Battery must be charged for a minimum of 8-12 hours prior to first use of the car to avoid damage to the battery. <b>Power switch must be in off position when charging.</b></li> </ul>	<ul style="list-style-type: none"> <li>Battery charger should be examined for damage prior to each use. It is important to inspect the cord and both ends for damage. If damage is found, <b>DO NOT USE THE CHARGER!</b> Contact us for replacement charger.</li> </ul>
<ul style="list-style-type: none"> <li>Please retain instruction manual for future reference.</li> </ul>	<ul style="list-style-type: none"> <li>Please retain packaging in the event it is necessary to return.</li> </ul>

**If the charger is plugged into the charging port, the car will not power up regardless if the charger is plugged into the wall outlet or not.**

List of Parts

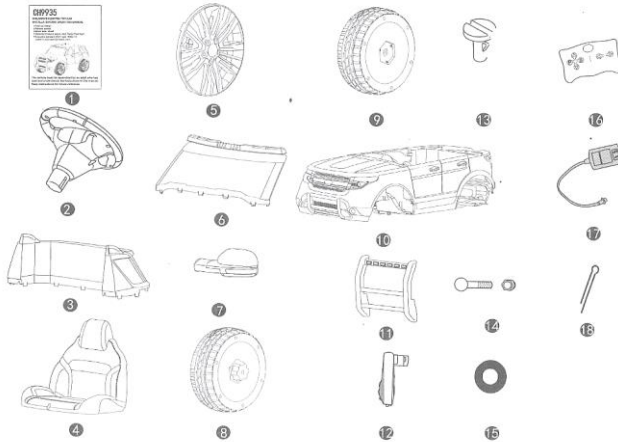

No.	Name of Part	Qty.	No.	Name of Part	Qty.	No.	Name of Part	Qty.
1	Manual	1	8	Rear Wheel w/Hub	2	14	Steering bolt/nut	1 ea.
2	Steering Wheel	1	9	Front Wheel	2	15	Washer	8
3	Rear Body Panel	1	10	Body	1	16	Remote Control	1
4	Seat	1	11	Lighted Front Push Bar	1	17	Charger	1
5	Wheel Cover	4	12	Motor/Gearbox	2	18	Cotter Pin	4
6	Windshield	1	13	Seat Screw	1	N/A	Large / Small Head Screws	16/10 ea.
7	Mirror	2	N/A	Door Windows (not pictured)	2	N/A	Body Support Brackets (not pictured)	2

**All assembly videos can be found on YouTube under SPORTrax**

# Assembly Instructions

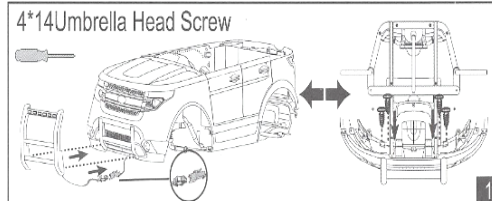

1. Connect the wire on the Lighted Push bar to the wire from the truck body. Turn the car over and insert screws.

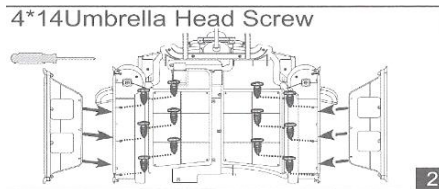

2. Place the Body Support Brackets on the truck body and install the screws.

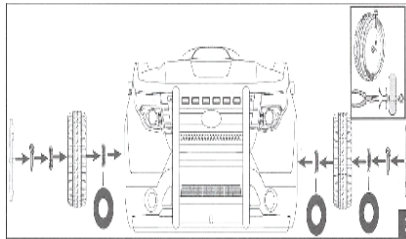

3. For each front wheel assembly, slide a washer onto the front axle. Slide front wheel onto the axle followed by a washer. Feed the cotter pin through the hole in the axle. Bend the cotter pin as shown. Install the wheel cover over the wheel snapping it into place.

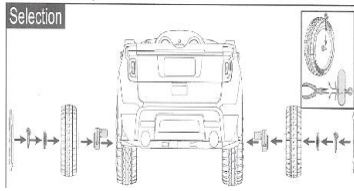

4. For each rear wheel assembly, place motor onto axle (threading wires into truck body) Place the rear wheel w/hub onto the axle. Then install the washer and feed cotter pin through the hole in the axle. Bend the cotter pin as shown and Install the wheel cover over the wheel, snapping it into place.

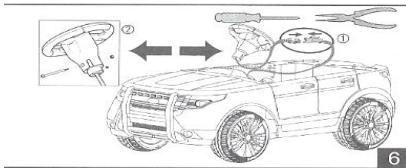

5. Remove the nut and bolt from the steering wheel. Connect the wiring harness on the steering wheel to the wiring from the steering column on the body of the car. Place the steering wheel into position on the steering column of the body of the car, making sure the holes in the column line up with the holes in the steering wheel. Feed the bolt through the holes that are lined up and thread nut onto bolt and tighten.

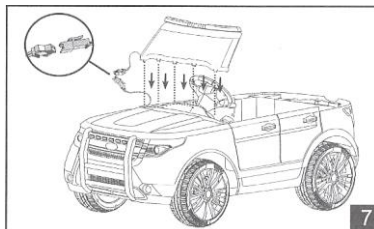

6. Connect the wire from the windshield to the wire from the car body. Line up the windshield with the body and push into the body of the truck.

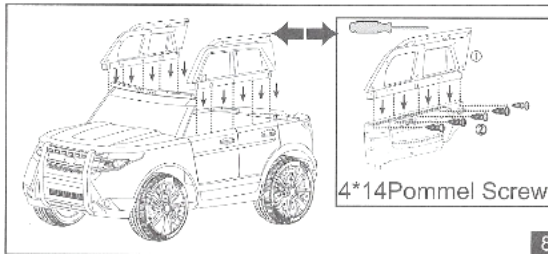

7. Push the Door Windows onto the door. Insert the Large head screws to secure the window to the door.

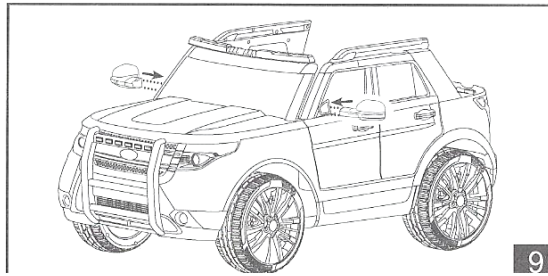

8. Push the rear view mirrors into place until an audible click is heard.

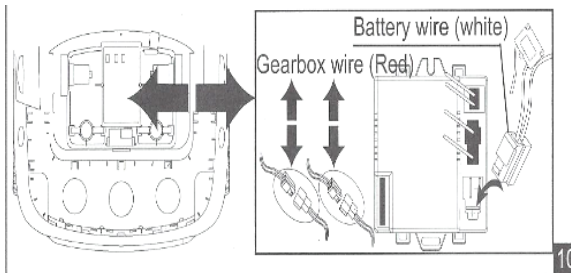

9. Connect the wiring harnesses from the motors to the wiring harnesses from the control box. Connect the wiring harness from the battery to the wiring harness from the control box.

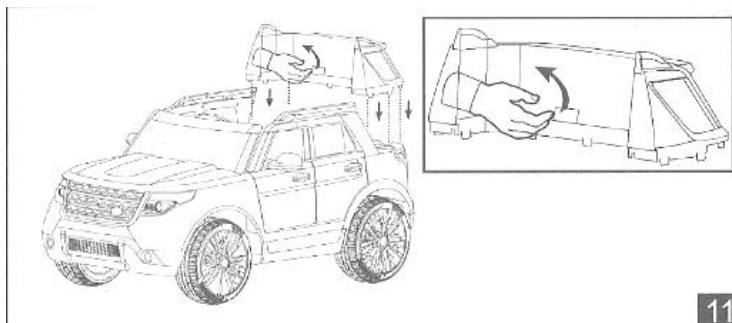

11

10. Place the rear body panel into position. Line up the tabs on the rear body panel with the body of the truck and snap into place.



12

11. Remove the seat screw. Place the seat into the truck body ensuring the two hooks on the back of the seat slide into the corresponding slots in the truck body. Re-insert the screw through the hole in the seat and tighten.

## Usage Instructions

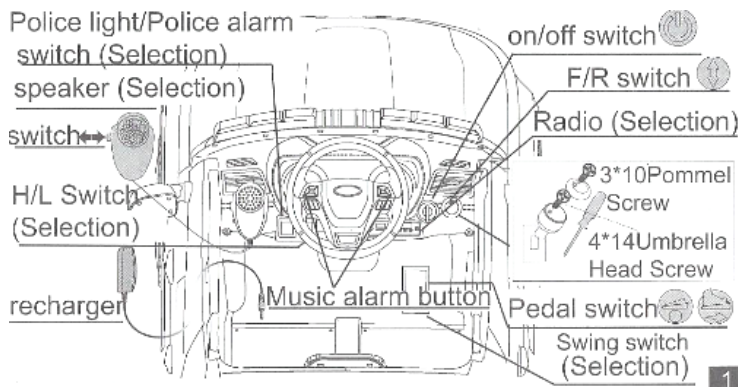

1. Initially charge the battery for 8-12 hours prior to first use. Remove the charger from the truck after charging. The truck will not work with the charger inserted into the car.

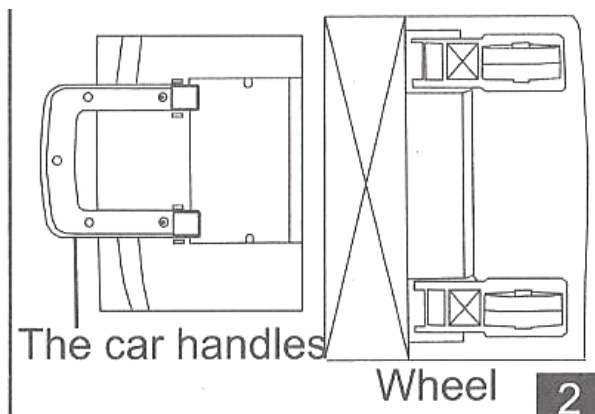

2. The truck is equipped with a handle and wheels under the car in the event the battery completely discharges and the truck needs to be moved.





**Remote Control Instructions:** For the first time use of remote control or after replacing the battery, you need to sync the remote to the car.

**a)** Install the remote control batteries (2 - AAA not included).

**b)** Hold the frequency key (large oval button toward top of remote) 2-4 seconds, the Low speed LED light should be flashing.

**c)** Turn on the car by pressing the Power button, the Low speed LED light should still be flashing and then turn to a steady light. If correct, then sync succeeded.

**d)** If the syncing failed (Low speed LED light still flashing), remove the batteries and repeat steps a – c.

**e)** Without operation of remote after 10 seconds the remote control indication light will go off and into power saving mode.

**f) Button Descriptions:**

▲ Forward ▼ Backward ◀ Turn Left ▶ Turn Right S = Speed  
– Push button for speed selection. There are 3 speed selections.  
P = Emergency brake, press it once to stop motion of car. Press again to restore the function of the car.

## **WARNING:**

- Use only the rechargeable battery and charger supplied with your vehicle. **NEVER** substitute the battery or charger with another brand. Using another battery or charger may cause damage.
- **NEVER** modify the electric circuit system. Tampering with the electric system may cause permanent damage to the system.
- **Do not** allow direct contact between battery terminals.
- **Do not** allow any type of liquid on the battery or its components.
- Charge the battery in a well-ventilated area **ONLY**. Do not charge near or around flammable materials.
- **NEVER** pick up the battery by the wires or charger. Damage can occur to the battery and may cause a fire. Pick up the battery by the case **ONLY**.
- Charge the battery in a dry area **ONLY**.

## **Wash hands after handling.**

- **Do not** open the battery. Battery contains lead acid and other materials that are toxic and corrosive.
- **Do not** open the charger. Exposed wiring and circuitry inside case could cause electric shock. **NEVER** allow a child to handle or charge the battery. Battery is heavy and contains lead acid (electrolyte).
- **Do not** drop the battery. Permanent damage to the battery could occur or cause serious injury.
- Before charging the battery, check for wear or damage to the battery, charger, its supply cord and the connectors. **DO NOT** charge the battery if any damage to parts has occurred.
- **Do not** allow the battery to drain completely. Recharge the battery after each use or once per month if not used regularly.
- **Do not** charge the battery upside down.
- **Always** secure the battery with the bracket. Battery can fall out and injure a child if vehicle tips over.
- The **Power Switch** must be turned in the **OFF** position when charging.
- When the car begins to run slowly, recharge the battery.

## **GENERAL MAINTENANCE:**

It is the parent's responsibility to check main parts of the toy before using. Regularly examine the car for potential hazard, such as damage to the battery, charger, cable or cord, and plug. Also, check that all screws are tightened throughout the car. In the event of such damage, the toy must not be used until that damage is repaired or replaced.

- Make sure the plastic parts of the vehicle are not cracked or broken.
- Occasionally use a lightweight oil to lubricate moving parts such as wheels.
- Park the vehicle indoors or cover it with a tarp to protect it from wet weather.
- Keep the vehicle away from sources of heat, such as stoves and heaters. Plastic parts may melt.
- Recharge the battery after each use. Only an adult should handle the battery. Recharge the battery at least once a month when not being used.
- Do not wash the vehicle with a hose. Do not wash the vehicle with soap and water. Do not drive the vehicle in rainy or snowy weather as water will damage the motor, electric system and battery.
- Clean the vehicle with a soft, dry cloth. To restore shine to plastic parts, use a non-wax furniture polish. Do not use car wax. Do not use abrasive cleaners.
- Do not drive the vehicle in loose dirt, sand or fine gravel which could damage moving parts, motors or the electric system.
- For extended times when the car will not be used, the power switch needs to be in the off position and the electrical connections should be disconnected from the battery.

## TROUBLE SHOOTING GUIDE:

Problem	Possible Cause	Possible Solutions
Car will not move	<ol style="list-style-type: none"> <li>1. Battery voltage is low.</li> <li>2. Battery connector or wires are loose.</li> <li>3. Battery is damaged or dead.</li> <li>4. Electrical box or motor is damaged</li> </ol>	Charge the battery Re-connect the battery connector to the car Replace battery  Replace motor
The battery will not charge.	<ol style="list-style-type: none"> <li>1. Battery connector may have come apart or have a bad connection.</li> <li>2. Battery charger plugged into a bad wall outlet.</li> <li>3. Battery charger is damaged.</li> </ol>	Re-connect the battery connector to the car electrical connector  Try another wall outlet  Replace battery charger
Shortened battery life	Battery was not charged fully Battery is old	Charge battery fully Change battery
Some Noise and heat when charging battery	Chemical reaction	Normal
Low Speed	Battery is old Battery is low on charge Weight limit exceeded  Uneven or uphill path Vehicle is being used in harsh conditions	Change the battery Charge the battery Do not exceed max weight limit  Use on flat surfaces Avoid using car in harsh conditions
Noise coming from motor/gearbox	Gear in motor/gearbox broken	Call for replacement motor
The car shakes when moving	Bad Connection of the motor wires Possible motor failure	Reconnect wires Call for replacement motor
Car needs a push to go forward	Poor contact of wires and/or connectors        "Dead Spot" on motor	Check that the battery connectors are firmly plugged into each other. If wires are loose around the motor, contact the distributor's service department  A dead spot means the electric power is not being delivered to the terminal connection. Call our service department

**Self-Resetting Breaker** – The vehicle is equipped with a self-resetting breaker. In the event the power is tripped the breaker will reset itself in approximately one minute.

If you are unable to solve a problem, please feel free to contact us.

Phone: 402-477-0541 or Email: [customerservice@rollinghillstrading.com](mailto:customerservice@rollinghillstrading.com)