



UTV SCREAMER 12V

Kids Ride on Vehicle

Assembly and Operation Instructions



Please read this instruction manual carefully. It is important to read and follow all of the steps during assembly to ensure proper operation and safety of the child. Please keep this manual for future reference.



**Scan this QR Code
to view the
Assembly Video**

SPECIFICATIONS:

Battery Type:	12V10AH	Avg. Speed:	2 – 3 MPH
Age Range:	2 – 6 Years	Charging time:	8-12 hrs -MAXIMUM Minimum 1 Charge per month
Max. Weight:	110 lbs	Avg. Use Time:	48-90 Minutes (depending on use)
Product Size:	49"L x 32"W x 32"H	Remote Battery:	2 - AAA (not included)

IMPORTANT!

<ul style="list-style-type: none"> Assembly of car and charging of battery by adult only.  	<ul style="list-style-type: none"> WARNING!! NOT TO BE USED ON STREETS or IN TRAFFIC.
<ul style="list-style-type: none"> Never modify the electric circuit system or tamper with electric system. Can cause permanent damage. 	<ul style="list-style-type: none"> Please check the product regularly for any loose parts or wires to ensure proper operation.
<ul style="list-style-type: none"> Adult supervision is recommended during operation by child to avoid injury. Safety equipment is recommended. 	<ul style="list-style-type: none"> Please make sure that the child uses caution to avoid falls and collisions causing injury to the child or third party.
<ul style="list-style-type: none"> Do not pick up vehicle by steering wheel. 	<ul style="list-style-type: none"> Do not pick up battery by wires or charger.
<ul style="list-style-type: none"> Keep all plastic bags out of the reach of young children. 	<ul style="list-style-type: none"> Not recommended for children under the age of 2 yrs. due to small parts that could cause a choking hazard.
<ul style="list-style-type: none"> Battery must be charged for a minimum of 8-12 hours prior to first use of the car to avoid damage to the battery. Power switch must be in off position when charging. 	<ul style="list-style-type: none"> Battery charger should be examined for damage prior to each use. It is important to inspect the cord and both ends for damage. If damage is found, DO NOT USE THE CHARGER! Contact us for replacement charger.
<ul style="list-style-type: none"> Please retain instruction manual for future reference. 	<ul style="list-style-type: none"> Please retain packaging in the event it is necessary to return for repair.

If the charger is plugged into the charging port, the car will not power up regardless if the charger is plugged into the wall outlet or not.

Parts List by Part Number:

NO.	Part Name	Qty	NO.	Part Name	Qty	NO.	Part Name	Qty
1.	Front Axle	1	7.	Front Roll Bar	1	13.	#5 Nut	1
2.	Gear Box	4	8.	Seat	1	14.	Remote	1
3.	Wheel	4	9.	Rear Roll Bar	1	15.	Charger	1
4.	#10 Washers	8	10.	Rear Axle	1	16.	4X16 Screw (Not in diagram to secure #7)	2
5.	Lock Nut	4	11.	Steering Wheel	1		(#10 Plastic Washers)	1
6.	Wheel Cover	4	12.	M5X40 Machine Screw	1		(#8 Plastic Washers)	4

• Assembly tools required:



Screwdriver
(not included)



Spanner



Hex wrench

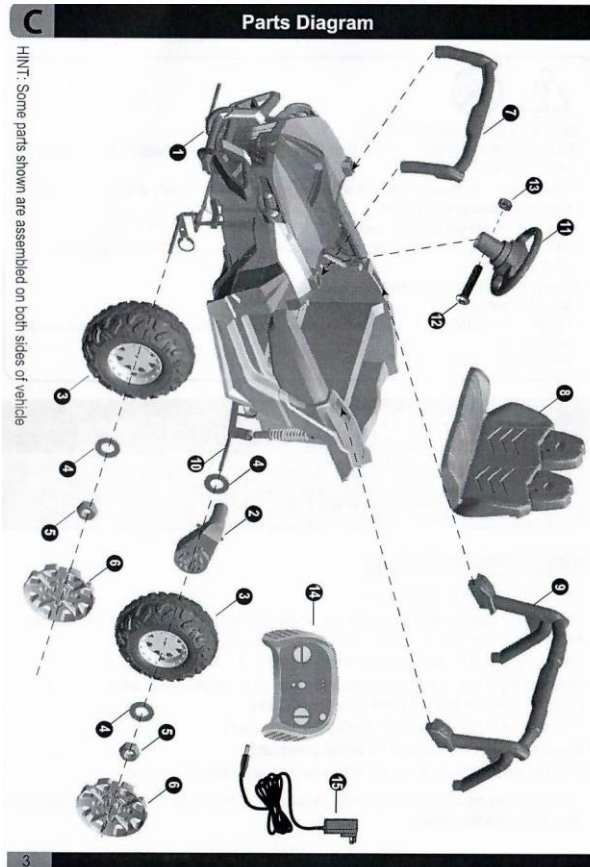

Assembly Instructions:

- Before using, the vehicle must be assembled by an adult. It takes about ten minutes to assemble the product.
- A Philips head screwdriver will be needed to attach the front roll bar.
- Do not allow children to play with parts or packaging.
- Check that all parts are present before beginning assembly.

[All assembly videos can be found on YouTube under SUPERtrax](#)

Attach the rear Shock Absorbers:

1. Turn the vehicle body upside down
2. Remove zip ties from the rear shocks to allow them to move freely.
3. Remove the hex nut and bolt, with two hex wrenches, from the end of the shock that is not connected to the body.
4. Align the holes on the rear axle frame with the holes in the shocks and reinstall the hex nut and bolt previously removed.

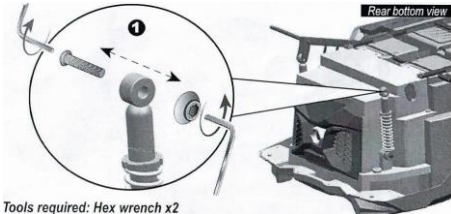

Tools required: Hex wrench x2

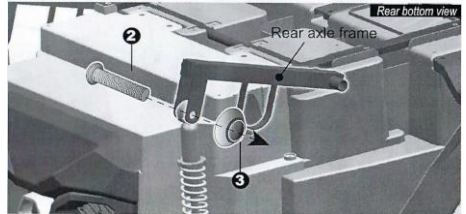

Installation of the Rear Axle & Wheels:

1. Cut off the plastic ties that secure the gear box to the rear axle frames.

Note: It is not necessary to disconnect the electrical connection.

2. Insert the rear axle into the holes on the rear axle frames as noted in picture below.

3. Slide the gear boxes onto the rear axle. **NOTE:** Slight downward pressure will need to be applied to the axle while sliding gear boxes onto axle to align the gear box access hole in the body with the gear box support in the rear axle frames. It is important to have gear boxes slid onto axle so that the gear box is touching the rear axle frames.

4. Slide a wheel onto each side of axle. **NOTE:** During this process, it is necessary to install the wheel with the hub adapter toward the body of the car and that you align the hub adapters with the gear boxes.

5. Slide washer onto each side of axle.

6. Thread on the locking nut to each side of the rear axle, tightening the nut using the tool provided. **NOTE:** Do not over tighten to avoid damage to the gear boxes. Two spanner wrenches are provided to hold the lock nut on each side of the axle while tightening the opposite lock nut.

7. Install wheel cover by aligning the tabs on the wheel cover with the slots in the wheel.

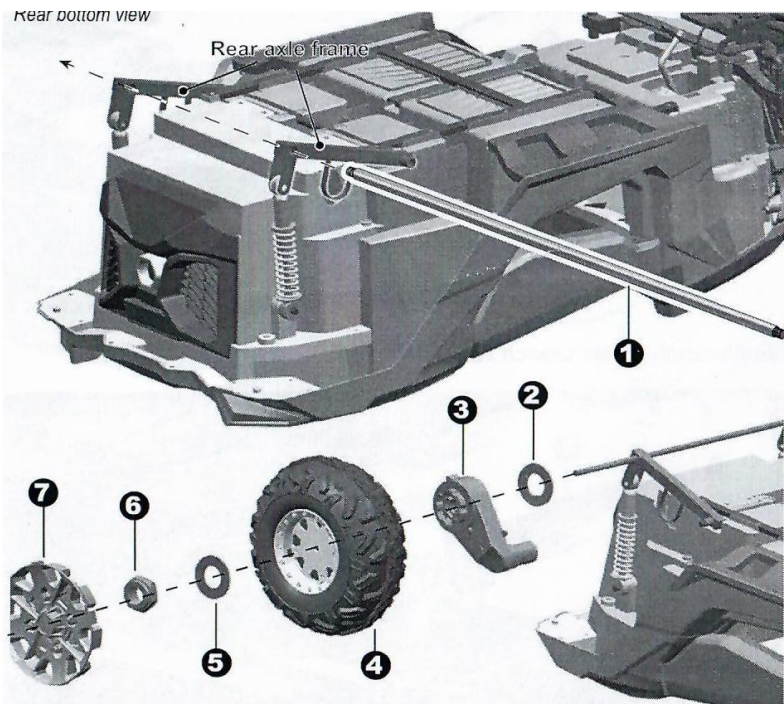

Installation of the Front Axle

1. Fit the front axle to the front of the vehicle.
2. Remove the screws, #8 washer, and the nuts from the shock absorbers with two hex wrenches. Line up the holes on the front axle frame with the holes on the front shock absorber, and reinsert the screw, #8 washer and fasten the nut on the opposite side, repeat for the other side.
3. Press the button located at the front of the hood and lift up. Slide a #4 washer and tighten a locknut with a spanner wrench.
4. Plug the drive motor connections into each other. Repeat for both sides.
5. Insert the bent end of the steering column into the hole on the front axle linkage. Fit a plastic washer (#10) to the bent end of the steering column and insert a split pin into the hole on the steering column, bend the ends of split pin back using long nose pliers (not included).

Hint: You may tighten the nuts on the shock absorber to adjust the tightness of the shock absorbers.

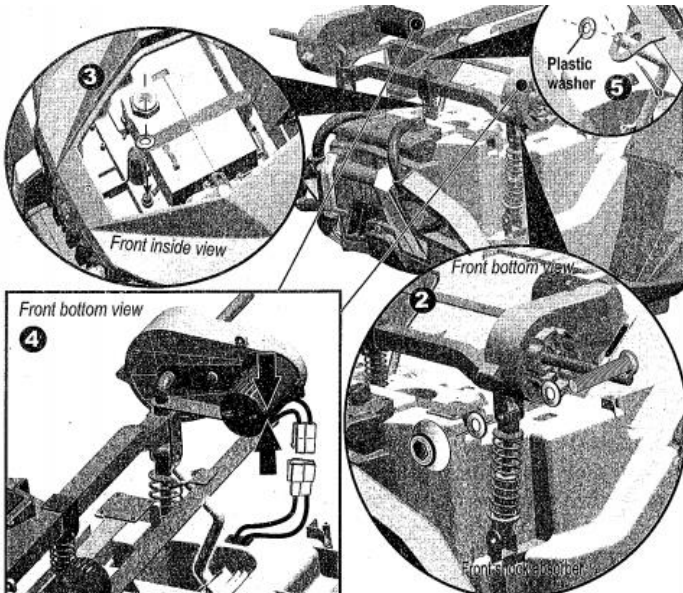
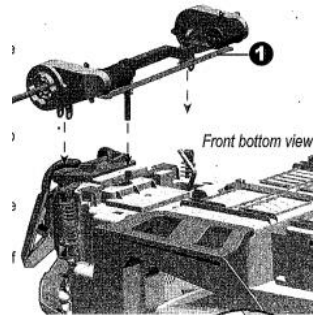

Installation of the Front Wheels:

1. While the vehicle body is upside down, slide the wheel onto the front axle. Aligning the tire with the gear box.
 2. Slide the washer onto the rear axle.
 3. Thread a lock nut onto the front axle, tightening the nut using the tool provided. NOTE: Do not over tighten to avoid damage to the gear box.
 4. Install wheel cover by aligning the tabs on the wheel cover with the slots in the wheel.
- (Repeat for driver side and passenger side).**

Front bottom view

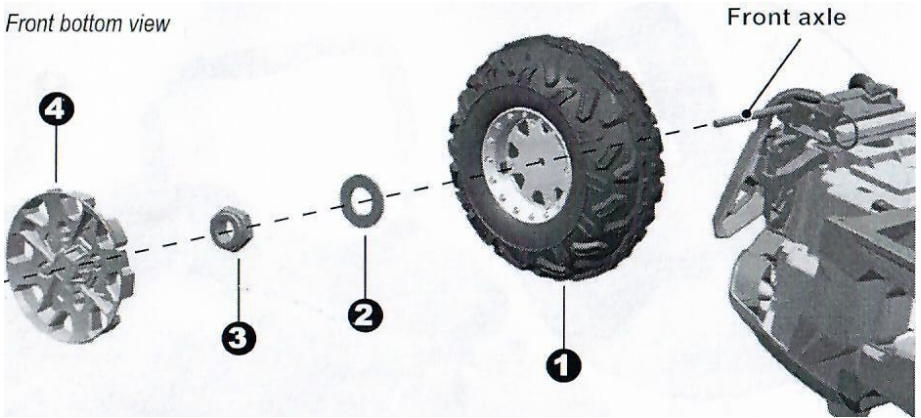

Steering Wheel Assembly

1. Connect the wires from the steering wheel to the wires located within the steering column on the vehicle.
2. Slide the steering wheel onto the steering column.
3. Align the hole through the base of the steering wheel, with the hole through the steering column. Insert steering screw (#13), followed by the nut.
4. Tighten the steering screw with a screwdriver.

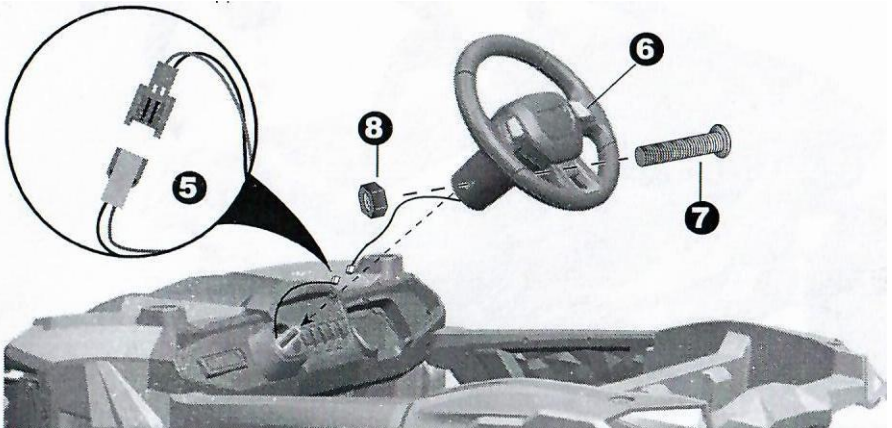

Installing Front and Rear Roll Bars

1. Insert the tabs of the front roll bar into the holes in the vehicle body. Push downward until you hear it click into place.
2. Insert two screws, one on each side, through the vehicle wall and into the front roll bar to secure it to the vehicle.
3. Insert the tabs of the rear roll bar into the holes in the vehicle body. Push downward until you hear it click into place.

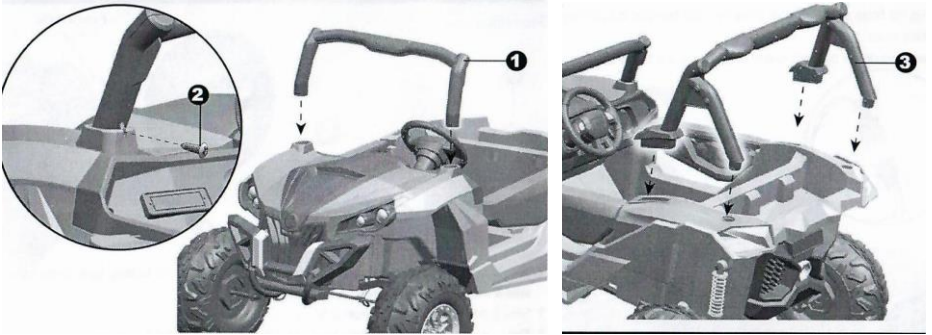

Installing the Seat

1. Align the slide groove on the bottom of the seat with the slide groove on the car body. Press the seat adjustment button while sliding the seat towards the back of the vehicle until the tabs on the back of the seat are inserted into the holes in the car body.

HINT: The seat is adjustable and has three positions. You can move the seat back as your child grows.

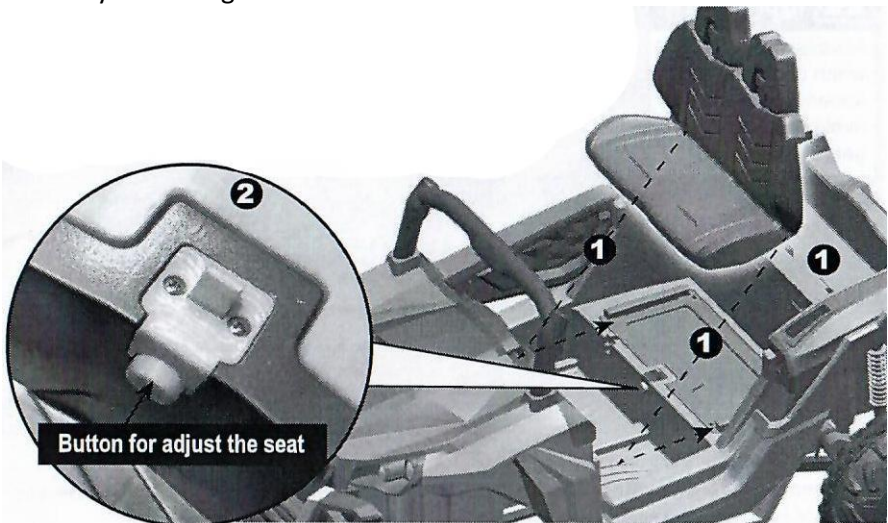

Connecting Vehicle to the Battery

1. Open the hood by pressing the hood button located on the front of the vehicle, as shown in figure 3, while lifting upward.
2. INSPECT WIRING, power connections should be red wire to positive (+) side of battery and black wire to negative (-) side of battery. Typically, these connections are made during the quality control inspection prior to shipping.
3. Check all remaining connectors to make sure all wiring is connected for proper operation.
4. Close the hood.

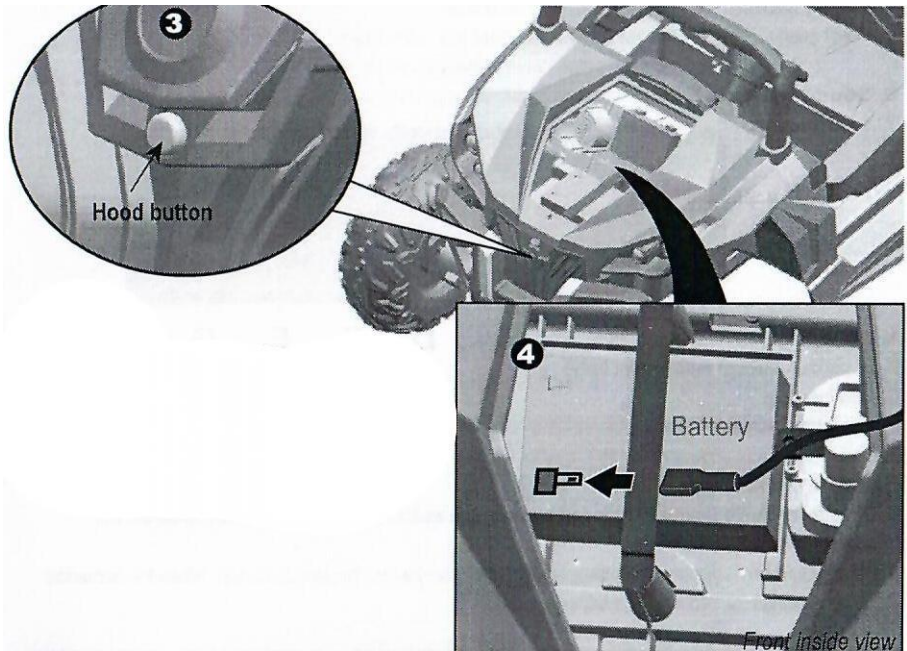

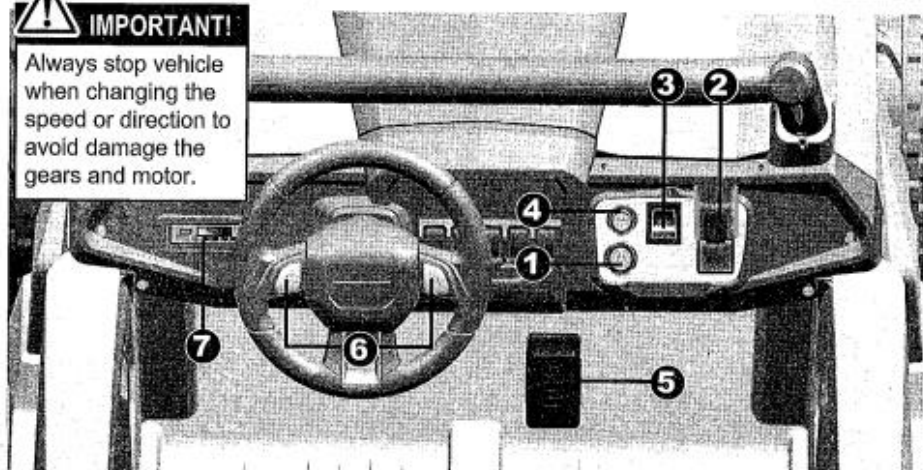

- 1. Power Switch:** Turns the vehicle on and off.
- 2. Forward/Reverse switch:** Changes the direction that vehicle moves from forward to reverse. The vehicle equipped with 3 speeds in forward: high speed / normal speed / low speed.
- 3. 2WD / 4WD switch:** Changes the vehicle moves in 2WD or 4WD mode.
- 4. Lights switch:** Turns the vehicle lights on and off.
- 5. Foot pedal:**
 - To move the vehicle, press the pedal down.
 - To brake or slow down, release pressure from the pedal.
- 6. Sound buttons:** Press for sound and horn playing. Long press for +/- volume.
- 7. Mp3 player:**

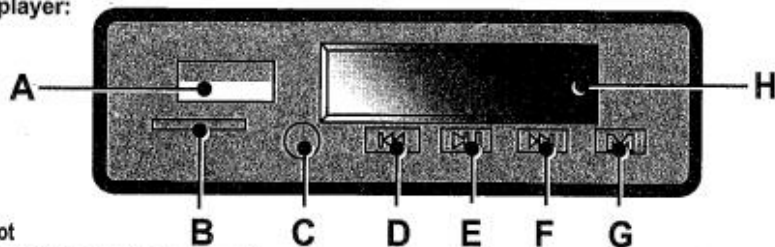

- A. USB slot**
- B. TF card slot (Read mp3 format only)**
- C. AUX input**
- D. Previous / Increase volume**
- E. Play / Pause**
- F. Next / decrease volume**
- G. Change the audio input (If you insert two or more audio input devices). It also controls the bluetooth and FM functions.**
- H. Display screen:** It displays the power level of the battery when the vehicle stops. When the numerical value is less than 12, recharge the battery please.

Connecting the Remote Control to the Car and Remote Control Function

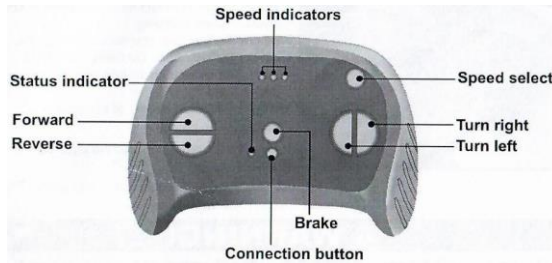

1. Install batteries.
2. Hold down the connection button for 2-5 seconds, the status indicator light will flash, release button and then turn on the car.
3. The status indicator light will stop flashing when the connection is successful.
4. Brake Button: Press button to stop vehicle. Press it again to release the brake.
5. Speed Button: Selects the level of speed for the vehicle (low, normal, or high speed).

BATTERY REPLACEMENT AND DISPOSAL:

The battery will eventually lose the ability to hold a charge. Depending on the amount of use, and varying conditions, the battery should operate for one to three years. Follow these steps to replace and/or dispose of the battery:

- Open the front hood of the vehicle
- Disconnect the battery connectors (Red).
- Position the battery lock switch to unlock. Carefully lift the battery - you may want to wear protective gloves before removal - **Do Not** lift the battery by its connectors or cables.
- Place the dead battery in a plastic bag.
- Replace the battery and reconnect the connectors.
- Close the Hood.

DO NOT LEAVE THE CAR ATTACHED TO THE CHARGER ANY LONGER THAN 12 HOURS TO AVOID DAMAGE

WARNING:

- Use only the rechargeable battery and charger supplied with your vehicle. **NEVER** substitute the battery or charger with another brand. Using another battery or charger may cause damage.
- **NEVER** modify the electric circuit system. Tampering with the electric system may cause permanent damage to the system.
- **Do not** allow direct contact between battery terminals.
- **Do not** allow any type of liquid on the battery or its components.
- Charge the battery in a well-ventilated area **ONLY**. Do not charge near or around flammable materials.
- **NEVER** pick up the battery by the wires or charger. Damage can occur to the battery and may cause a fire. Pick up the battery by the case **ONLY**.
- Charge the battery in a dry area **ONLY**. **Wash hands after handling**.
- **Do not** open the battery. Battery contains lead acid and other materials that are toxic and corrosive.
- **Do not** open the charger. Exposed wiring and circuitry inside case could cause electric shock. **NEVER** allow a child to handle or charge the battery. Battery is heavy and contains lead acid (electrolyte).
- **Do not** drop the battery. Permanent damage to the battery could occur or cause serious injury.
- Before charging the battery, check for wear or damage to the battery, charger, its supply cord and the connectors. **DO NOT** charge the battery if any damage to parts has occurred.
- **Do not** allow the battery to drain completely. Recharge the battery after each use or once per month if not used regularly.
- **Do not** charge the battery upside down.
- **Always** secure the battery with the bracket. Battery can fall out and injure a child if vehicle tips over.
- The **Power Switch** must be turned in the **OFF** position when charging.
- When the car begins to run slowly, recharge the battery.

GENERAL MAINTENANCE:

It is the parent's responsibility to check main parts of the toy before using. Regularly examine the car for potential hazard, such as damage to the battery, charger, cable or cord, and plug. Also, check that all screws are tightened throughout the car. In the event of such damage, the toy must not be used until that damage is repaired or replaced.

- Make sure the plastic parts of the vehicle are not cracked or broken.
- Occasionally use a lightweight oil to lubricate moving parts such as wheels.
- Park the vehicle indoors or cover it with a tarp to protect it from wet weather.
- Keep the vehicle away from sources of heat, such as stoves and heaters. Plastic parts may melt.
- Recharge the battery after each use. Only an adult should handle the battery. Recharge the battery at least once a month when not being used.
- Do not wash the vehicle with a hose. Do not wash the vehicle with soap and water. Do not drive the vehicle in rainy or snowy weather as water will damage the motor, electric system and battery.
- Clean the vehicle with a soft, dry cloth. To restore shine to plastic parts, use a non-wax furniture polish. Do not use car wax. Do not use abrasive cleaners.
- Do not drive the vehicle in loose dirt, sand or fine gravel which could damage moving parts, motors or the electric system.
- For extended times when the car will not be used, the power switch needs to be in the off position and the electrical connections should be disconnected from the battery.

**DO NOT LEAVE THE CAR ATTACHED TO THE
CHARGER ANY LONGER THAN 12 HOURS TO
AVOID DAMAGE**

TROUBLE SHOOTING GUIDE:

Problem	Possible Cause	Possible Solutions
Car will not move	<ol style="list-style-type: none"> 1. Battery voltage is low. 2. Battery connector or wires are loose. 3. Battery is damaged or dead. 4. Electrical box or motor is damaged 	Charge the battery Re-connect the battery connector to the car Replace battery Replace motor
The battery will not charge.	<ol style="list-style-type: none"> 1. Battery connector may have come apart or have a bad connection. 2. Battery charger plugged into a bad wall outlet. 3. Battery charger is damaged. 	Re-connect the battery connector to the car electrical connector Try another wall outlet Replace battery charger
Shortened battery life	Battery was not charged fully Battery is old	Charge battery fully Change battery
Some Noise and heat when charging battery	Chemical reaction	Normal
Low Speed	Battery is old Battery is low on charge Weight limit exceeded Uneven or uphill path Vehicle is being used in harsh conditions	Change the battery Charge the battery Do not exceed max weight limit Use on flat surfaces Avoid using car in harsh conditions
Noise coming from motor/gearbox	Gear in motor/gearbox broken	Call for replacement motor
The car shakes when moving	Bad Connection of the motor wires Possible motor failure	Reconnect wires Call for replacement motor
Car needs a push to go forward	Poor contact of wires and/or connectors "Dead Spot" on motor	Check that the battery connectors are firmly plugged into each other. If wires are loose around the motor, contact the distributor's service department A dead spot means the electric power is not being delivered to the terminal connection. Call distributor service department

Self-Resetting Breaker – The vehicle is equipped with a self-resetting breaker. In the event the power is tripped the breaker will reset itself in approximately one minute.

If you are unable to solve a problem, please feel free to contact us.

Phone: 402-477-0541 or Email: customerservice@rollinghillstrading.com